



Firebox Liner Kit

Model # 24-B-FBK,
30-B-FBK,
36-B-FBK



| Model | Part No. | Parts List | | | | | |
|-------|----------|------------------|----------------------|---------------|---------------|----------------|-------------|
| | | Tubular burner * | Firebox liner pieces | Drive screw † | Bracket screw | Bracket washer | Bracket nut |
| 24" | 24-B-FBK | 2 | 6 | 12 | 4 | 4 | 4 |
| 30" | 30-B-FBK | 3 | 6 | 12 | 4 | 4 | 4 |
| 36" | 36-B-FBK | 3 | 6 | 12 | 4 | 4 | 4 |

* Not shown

† Includes 4 extra drive screws

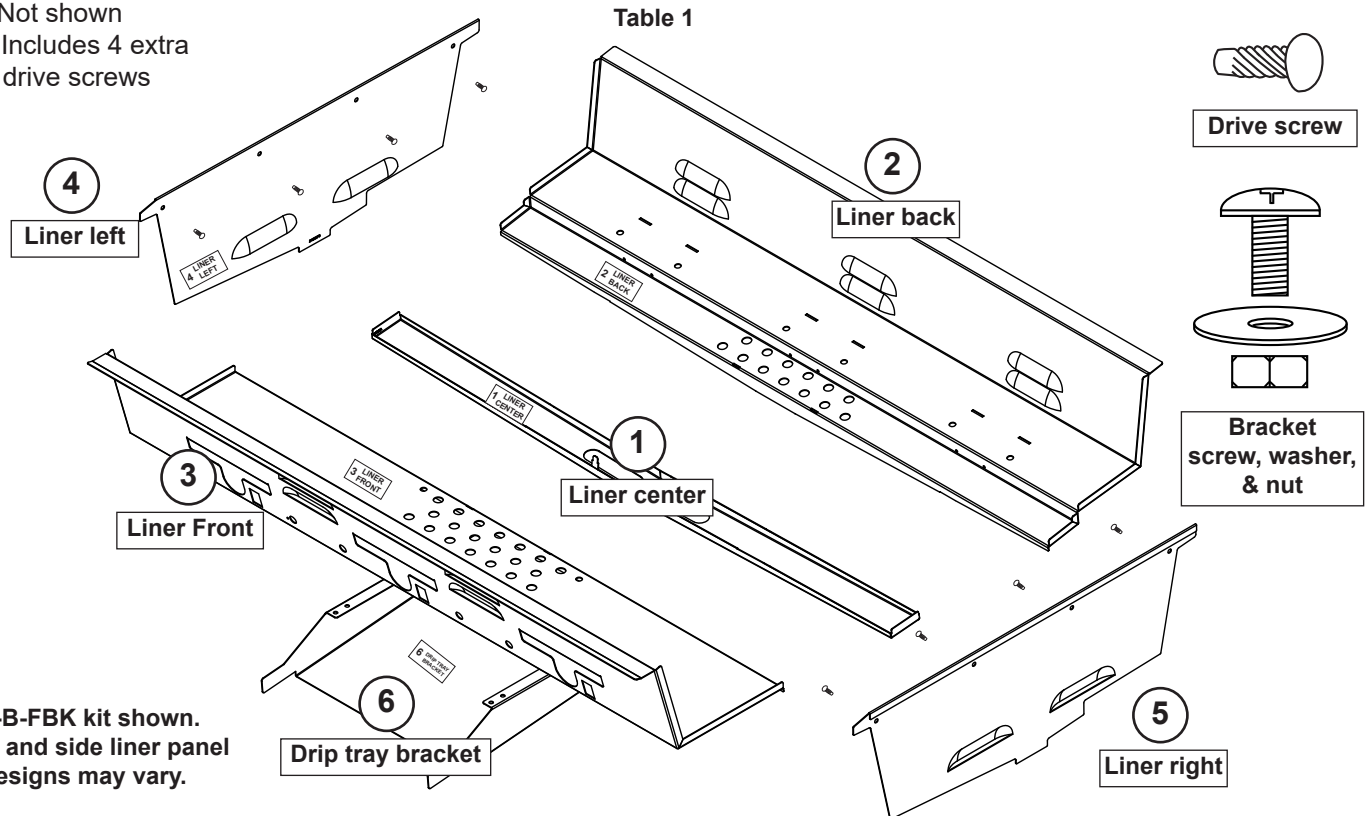

This firebox liner kit is for installation on AOG grills. Installation on a 36" unit is depicted in this instruction.

READ THESE INSTRUCTIONS CAREFULLY BEFORE STARTING INSTALLATION.

Tools required: Gloves, Phillips screwdriver, flat head screwdriver, rubber mallet, pliers, needle-nose pliers, hammer, 3/8" nut wrench, and power drill with a 3/16" drill bit.

Be sure the grill is completely cool and the gas is completely shut off, and the power is disconnected (if applicable).

IMPORTANT: CLEAN THE INTERIOR OF THE GRILL OF ALL DEPOSITS AND GREASE PRIOR TO INSTALLING THE FIREBOX LINER KIT.

Note: Wear gloves whenever installing and handling this liner kit as some components have sharp edges.

I As applicable, remove the warming rack, cooking grids, vaporizer panels, tubular burners, tubular burner igniters (except T-series), infrared main burner, infrared main burner igniter, and open the control panel. Reference your owner's manual for removal details if needed.

Note: The **tubular burners** that are being removed from your grill are no longer needed and may be properly discarded. This kit includes new tubular burners for replacement. If equipped, retain the infrared main burner for later re-installation.

Inspect the grill drip tray bracket underneath the unit. If the original grill firebox no longer provides support to the drip tray bracket, remove and discard the old drip tray bracket by drilling through the supporting rivets.

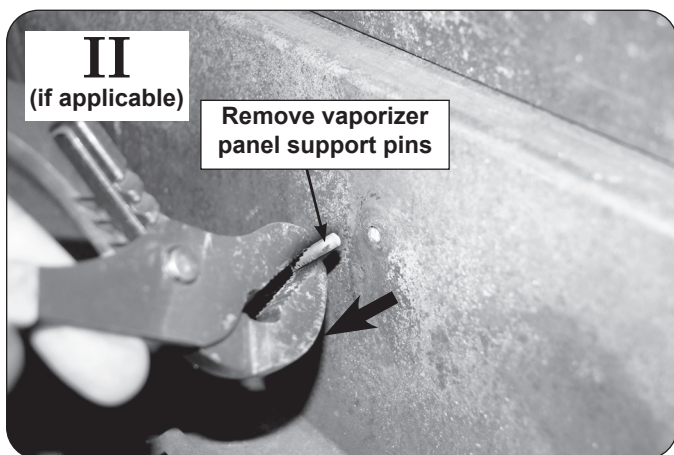

If vaporizer panel support pins exist on the rear firebox wall of the grill, remove those pins using pliers as the new tubular burners (included in this kit) will provide support for the vaporizer panels.

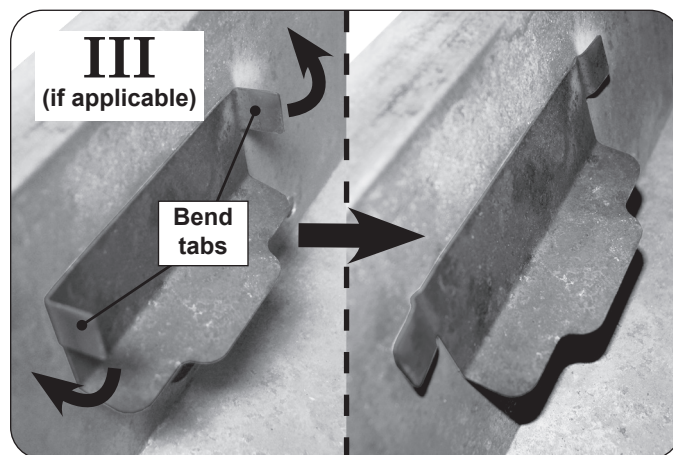

If baffles exist on the front firebox wall, the tabs must be bent back flat against the grill front firebox wall. Use pliers to fold the tabs flat on all baffles.

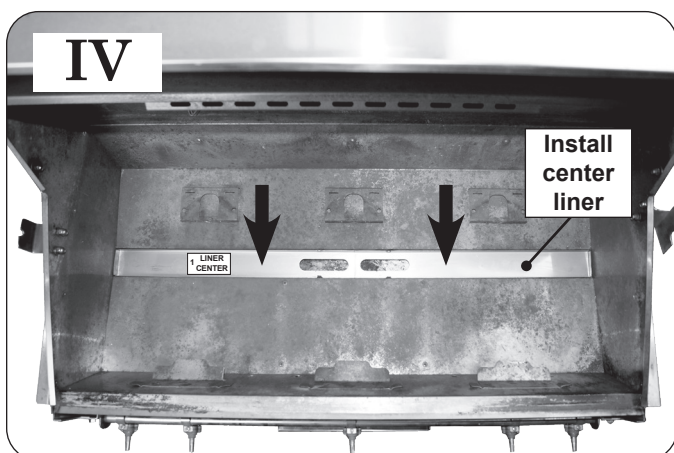

Place the center liner (item 1) onto the grill drainage channel. Ensure the liner rests flat in place.

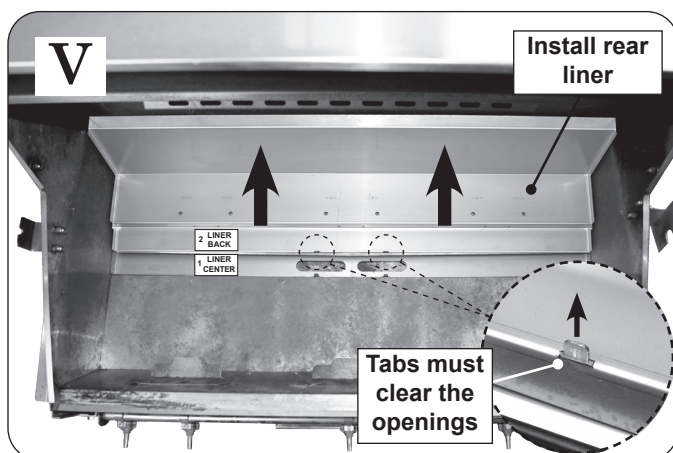

Place the rear liner (item 2) ensuring it rests flat against grill rear firebox wall. The two tabs (on center liner) must extend up through the slots in the rear liner.

Note: If needed, use a rubber mallet to assist in proper placement of liner panels.

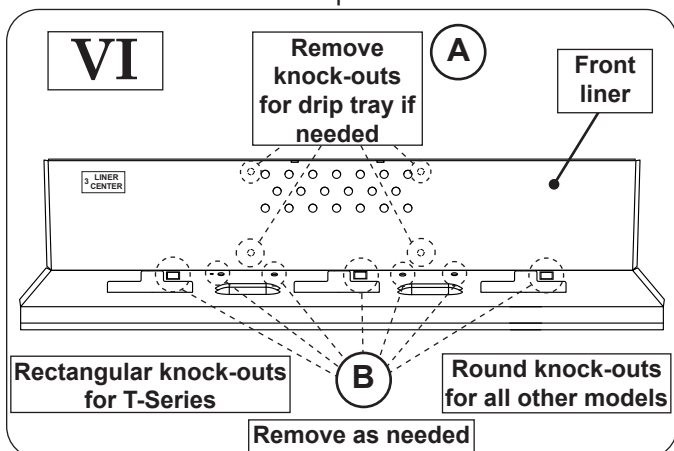

The front liner (item 3) has 4 knock-outs that align to the drip tray bracket below the unit once installed. If the old drip tray bracket was previously removed, remove the knock-outs using a flat head screwdriver. These new holes will be used to provide support to the new drip tray bracket. See A above.

The front wall of this liner also includes knock-outs to accommodate your ignition system. Refer to the holes on your existing grill firebox and remove the necessary knock-outs accordingly to your unit. For T-series models, remove rectangular knock-outs. For all other models, remove round knock-outs. See B above.

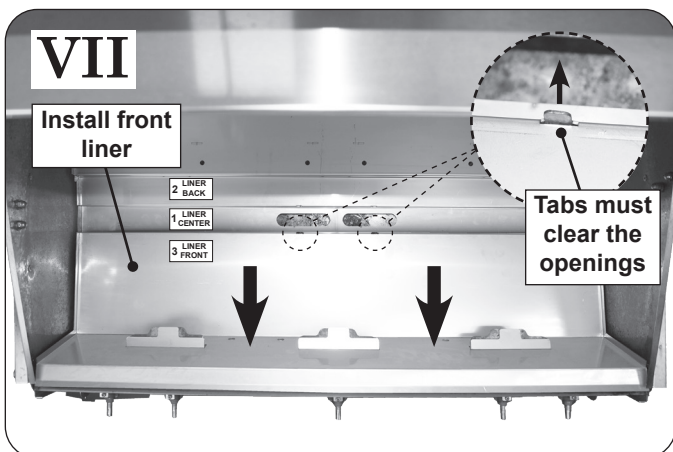

Place the front liner (item 3) ensuring it rests flat against the grill front firebox wall, and the two tabs (on center liner) extend up through the slots in the front liner.

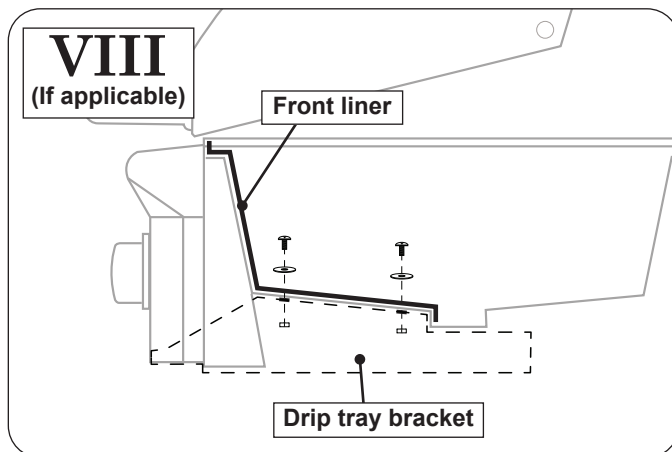

If the knock-outs were removed in step VI, install the new drip tray bracket (item 6) to the front liner using the supplied bracket screws, washers, and nuts. Fully tighten using a Phillips screwdriver and a 3/8" nut wrench.

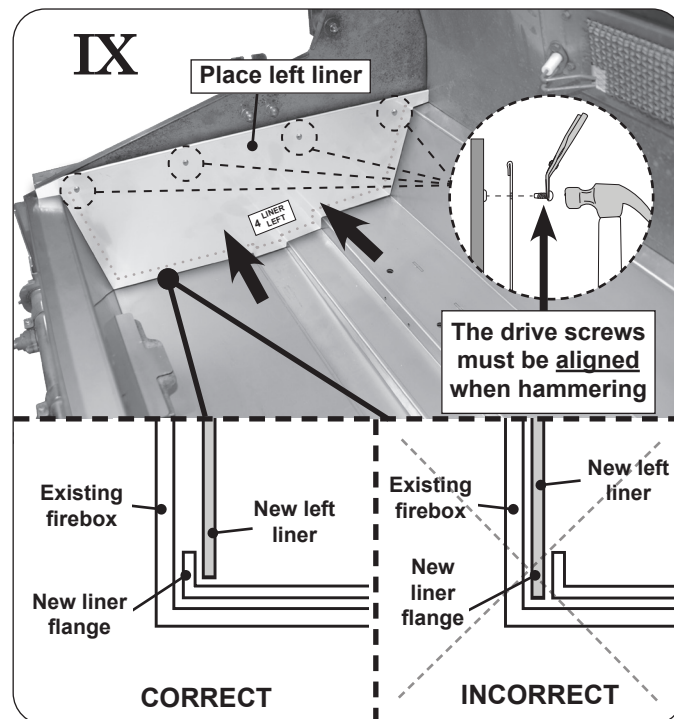

Place the left liner (item 4) as shown above. Rest the liner **OVER the front and rear liner flanges** (hiding the flanges) and ensure the 4 holes are aligned with the 4 grill wall rivets. To secure the liner, align each drive screw (included in kit) with the corresponding hole and carefully hammer each drive screw into the panel. Use needle-nose pliers to assist in holding the drive screws properly.

Note: The drive screw will force out the center of the existing rivet. Therefore, ensure to use ample force when driving the screw through the retaining rivet.

REPEAT THIS STEP FOR THE RIGHT LINER (item 5).

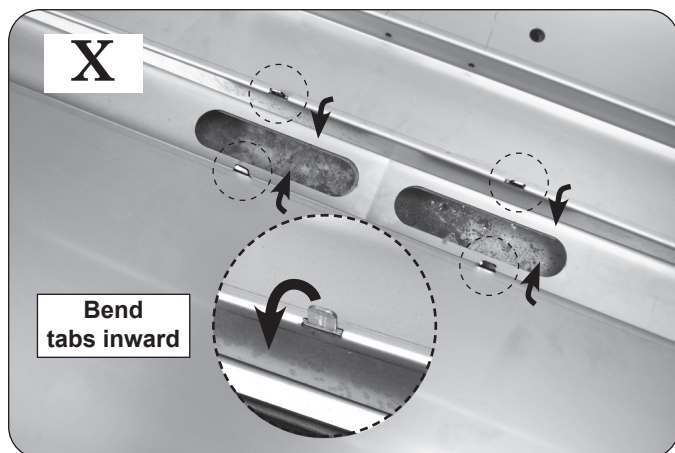

Using pliers, bend in the four tabs inward toward the middle of the center liner to lock the liner panels together.

XII

Install the new tubular burners, then reinstall the infrared main burner (if equipped), the vaporizer panels, cooking grids, warming rack, and control panel.

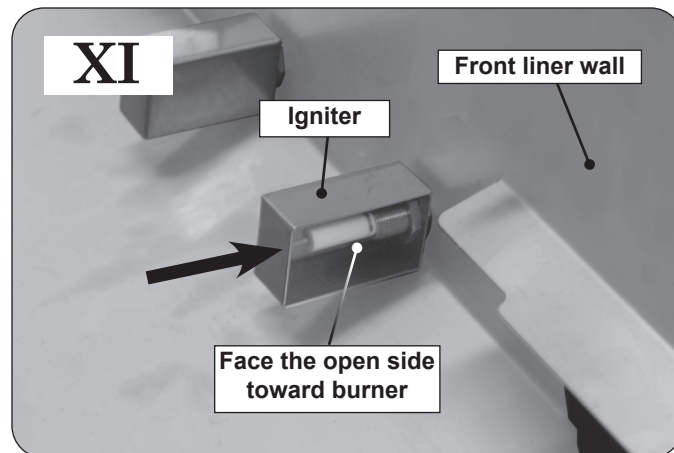

Reinstall the igniters (previously) into the front liner wall. Each igniter is to be placed from the interior of the grill, with the open side facing towards the burner. Fasten from the opposite side (behind face) using the included nut.

Connect each igniter to the corresponding igniter wire.

NOTES PAGE

Please use this page to record any information about your unit that you may want to have at hand.